

TUAKANA



General Details

VESSEL TYPE	Harbour / Coastal Tug , Lloyds +100A1 Tug
YEAR BUILT/BUILDER	1996, Marine Steel, Whangarei New Zealand
REGISTRY	New Plymouth
CALLSIGN	ZM2000
IMO NUMBER	9134529
MNZ NUMBER	MSA 106193
GRT	347T
MMSI NUMBER	512000224
DISPLACEMENT (Departure)	534T
DEADWEIGHT	98.7T
OPERATING LIMITS	NZ Offshore

Dimensions

LOA	30.5m
BEAM	11m
DRAFT	4.83m

Performance

BOLLARD PULL	40 T
SEA SPEED	12 kts

Tank Capacities

FUEL CAPACITY	83,688litres
FRESH WATER CAPACITY	101,215 litres
FIRE FIGHTING FOAM – AFFF	14,128 litres
FIRE FIGHTING FOAM – PYROCOOL	1200 litres
WASTE OIL AND BILGE WATER	2400 litres

TUAKANA

Machinery

MAIN ENGINES	2 x Wartsila 9L20 1450kW @ 1000 rpm
PROPELLERS	2 x Voith 28GII 185
GENERATORS	2 x Cat 3306B 50HZ @ 1500 RPM, 3 Phase, 180kva, 140kw
GENERAL SERVICE PUMPS	2 x Desmi 80-70-175 65m ³ /hr
SEWAGE TREATMENT	Hamworthy STO 10person
OILY WATER SEPERATION	Comyn 0.25m ³ /hr
ENGINE ROOM FIRE PROTECTION	CO2

Deck Equipment

TOWING WINCH	Jaden Hydraulic 80T Brake holding, 10T haul, 50m/min line speed @bare drum, Freewheel capable.
AFT TUGGER WINCH	Jaden Hydraulic 3T
TOWING ARRANGEMENT	HARBOUR 180m x 88mm SSR1200 Main Line. 15m x 41mm Amsteel Blue Pennant OFFSHORE 550m x 42mm wire, 60m Nylon Stretcher, Various 42mm pennants
WINDLASS	Jaden Hydraulic 3T single Gypsy, Wire Drum, Drum End
ANCHORS/CABLE	2 x Hall Pattern 480kg / 1 x 19U2 x 11shackle Stbd, 28mm wire Port
TOWING HOOK	40T capacity with remote quick release
STAPLE	Removable bolted with Stainless/steel lining
DECK CRANE	Palfinger PK8000 - 4300kg @2m, 750kg at 9m, wire winch @1.2T

Fire Fighting

TOTAL CAPACITY	22,000litres/min
PUMPS	2 X Super Titan 630 - 630m ³ /hr - Main Engine Driven
MONITORS	2 X Hydraulic remote operated
FOAM INDUCTION	'Round the Pump' - Variable 1.5% to 6%

Accommodation/LSA Equip.

GENERAL	LSA and Certificate for 6 Persons
CABINS	3 X 2 Berth Air Conditioned
LIFERAFTS	2 x RFD 8 man SOLAS B
RESCUE BOAT	NAIAD 4.3m Aluminium Rigid hull Inflatable/30Hp Suzuki Outboard with Global Davits SOLAS approved Launch and recovery Davit

Navigation and Communication

SSB RADIO	1 x JMC TR 1500 DIGITAL
VHF RADIO	2 x JRC 1 x Standard Horizon, 2x Portable
RADAR	Faruno NAVNet VX2 Radar/Plotter Radome-2.2kw for M1824C - 24NM
GPS/PLOTTER	Seiwa Tiger GPS to NAVNet Plotter Screen
SOUNDER	JRC JFV850
AUTOPILOT	Comnav 2800
AIS	Furuno navigator
MAGNETIC COMPASS	Saura MR 150A

TUAKANA

While her primary duty is as a capable ship assist tug for harbour duties, Tuakana is a versatile multi-role vessel which can be quickly reconfigured for coastal towage, offshore standby or as an offshore cargo supply vessel.



With Towing Staple removed and Cargo Deck Rails in place, Tuakana has capacity for 2 x 20ft containers or 20T of equivalent cargo on deck



Configured for Offshore towage, Tuakana has assisted oil rigs on coastal voyages, positioning and offloads, as well as towing disabled vessels to shelter.

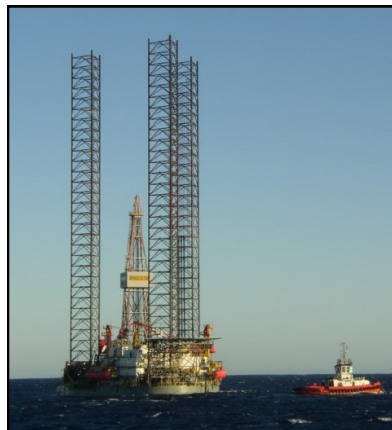

TUAKANA

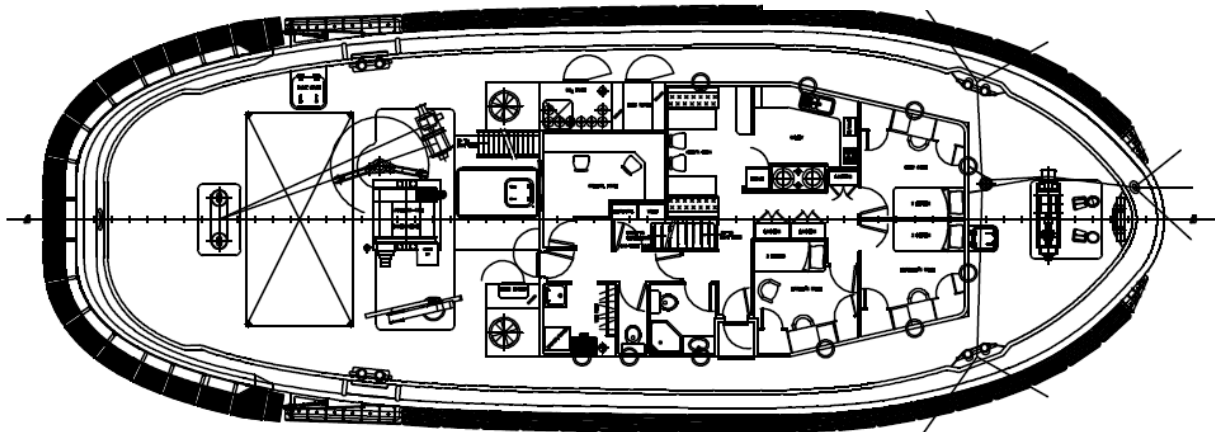
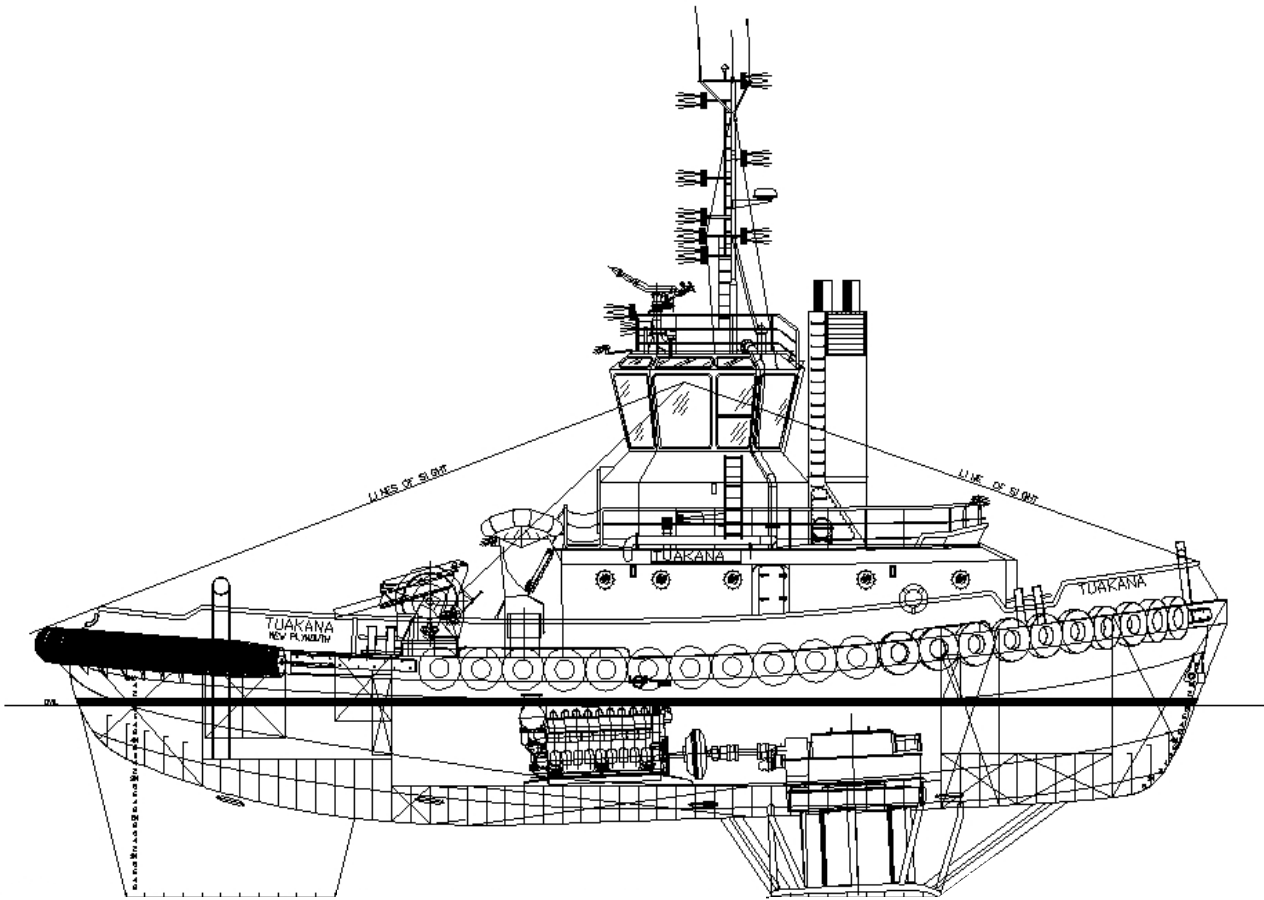

MAIN DECK

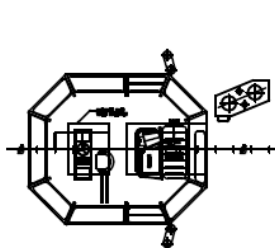

WHEELHOUSE DECK

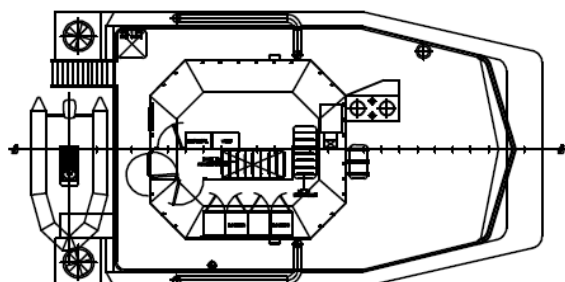

BOAT DECK